

SURFACES LEGEND

	ASPHALT
	CONCRETE
	BOARDWALK/BRIDGE
	NATURAL SURFACE TRAIL

SHEET C1.4 IMPACTS

STREAM - AREA A	403 LF
TOTAL STREAM IMPACT	403 LF
TOTAL WETLAND IMPACTS	NONE

- GRADING NOTES:**
- 1.) ALL LONGITUDINAL SLOPES OF SIDEWALK SHALL BE LESS THAN 5%
 - 2.) CROSS SLOPE OF ALL SIDEWALK SHALL BE LESS THAN 2%
 - 3.) MAX SLOPE OF PEDESTRIAN RAMPS SHALL BE LESS THAN 8.33%
 - 4.) ALL SLOPES OF LANDSCAPED AREAS SHALL HAVE POSITIVE DRAINAGE.
 - 5.) THE TERMINATIONS OF PROPOSED HARDSCAPE ELEMENTS SHALL TIE FLUSH WITH GRADE AND NO TRIP HAZARDS SHALL BE CREATED.
 - 6.) ALL LANDSCAPE AREAS SHALL BE SMOOTH AND HAVE POSITIVE DRAINAGE. NO PONDING SHALL OCCUR.
 - 7.) ANY GRADING PROBLEMS THAT ARISE DURING CONSTRUCTION SHALL BE BROUGHT TO THE ATTENTION OF THE ENGINEER/LANDSCAPE ARCHITECT BEFORE HARDSCAPE ITEMS ARE INSTALLED.

GENERAL GRADING NOTE:
TRAIL SURFACE SHALL MATCH EXISTING GRADE UNLESS SHOWN OTHERWISE. TRAIL TO RAMP TO BOARDWALK ELEVATION AT A MAX SLOPE OF 12:1 OR 8.33%. ALL GRADES OF TRAIL SHALL MEET THE REQUIREMENTS OF THE U.S. FOREST SERVICE TRAIL ACCESSIBILITY GUIDELINES.

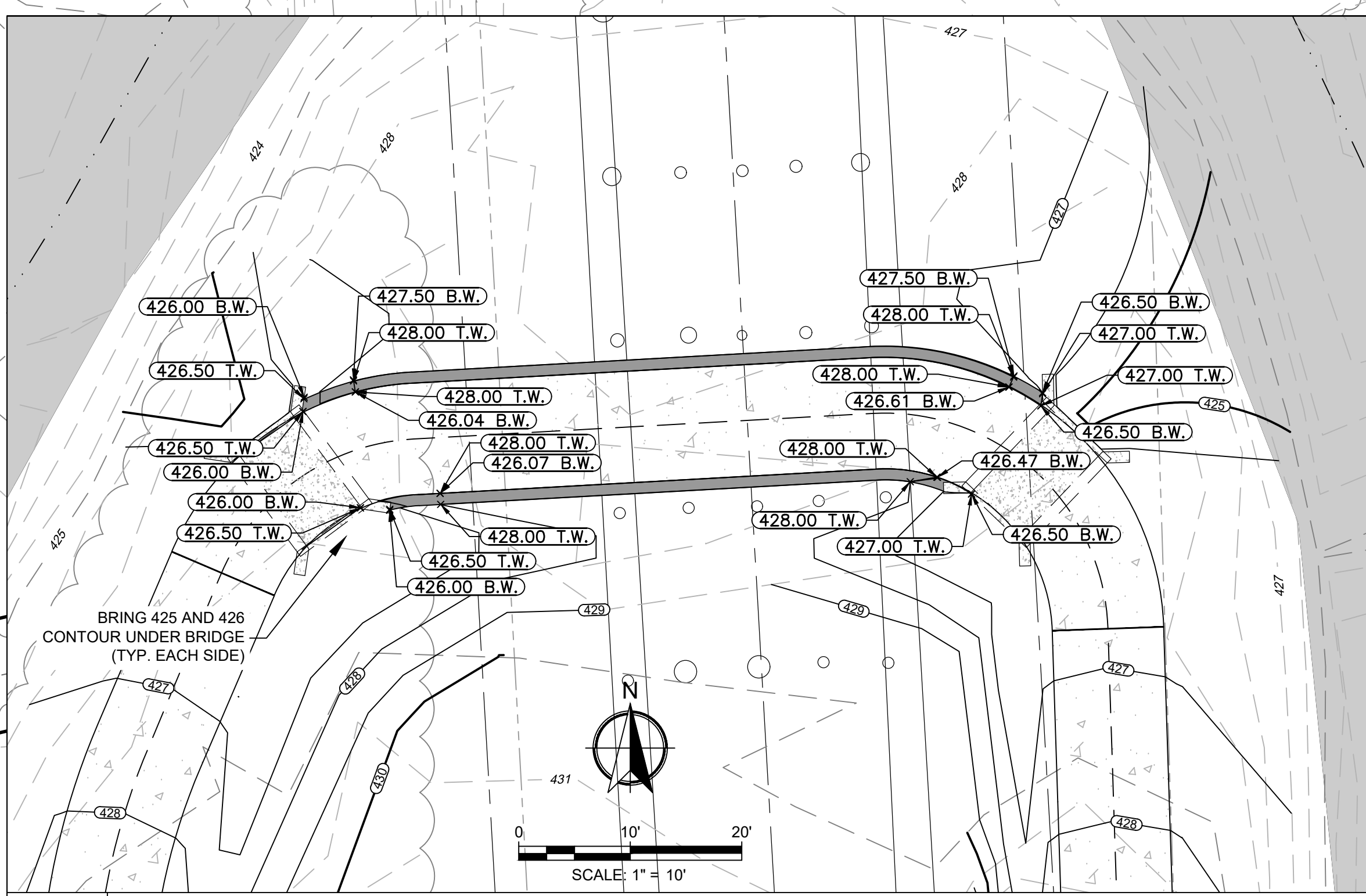
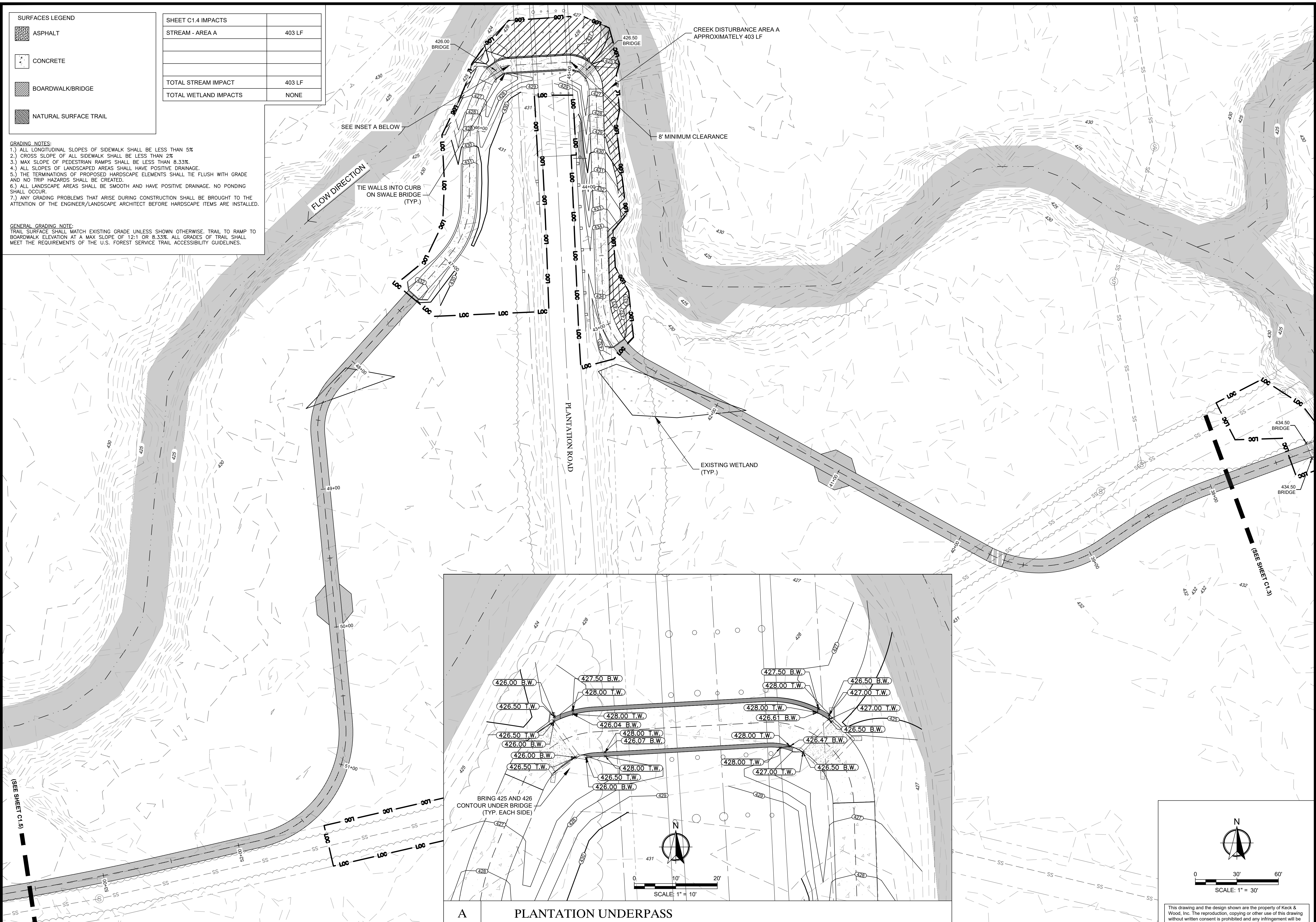

A PLANTATION UNDERPASS

PH. II MAIN TRAIL STA: 37+80 TO 53+50

Keck+Wood
COLLABORATION BY DESIGN
300 TECHNOLOGY CENTER WAY, SUITE 400
ROCK HILL, SC 29730
(803) 620-1300
keckwood.com

STATE OF SOUTH CAROLINA
REGISTERED PROFESSIONAL LANDSCAPE ARCHITECT
No. 1147
TRIP BARRINEAU
LICENSEE

STATE OF SOUTH CAROLINA
REGISTERED PROFESSIONAL ENGINEER
No. 006617
KECK & WOOD, INC.
DATE OF AUTHORIZATION

NO.	DATE	REVISION

Lindsay Pettus Greenway
Phase II
Lancaster, South Carolina
Grading and Drainage Plan

BID SET

Project Manager:	Tripp Barrineau, PLA
Drawn By:	SDG
Checked By:	CEB
Date:	07/08/2022
Scale:	As Shown
Project No.:	196770
Drawing No.:	C1.4

North arrow and scale bar (1" = 30').

This drawing and the design shown are the property of Keck & Wood, Inc. The reproduction, copying or other use of this drawing without written consent is prohibited and any infringement will be subject to legal action.
© 2020 Keck & Wood, Inc.

TRAIL SIGNAGE LEGEND

1	PRIMARY TRAIL HEAD KIOSK
2	SECONDARY TRAIL HEAD MARKER
3	DIRECTIONAL & INFORMATIONAL SIGNAGE
4	MILE MARKER & INTERPRETIVE SIGNAGE
5	DIRECTIONAL & INFORMATIONAL SIGNAGE
6	LOW CLEARANCE SIGNAGE
7	EMERGENCY LOCATOR SIGNAGE

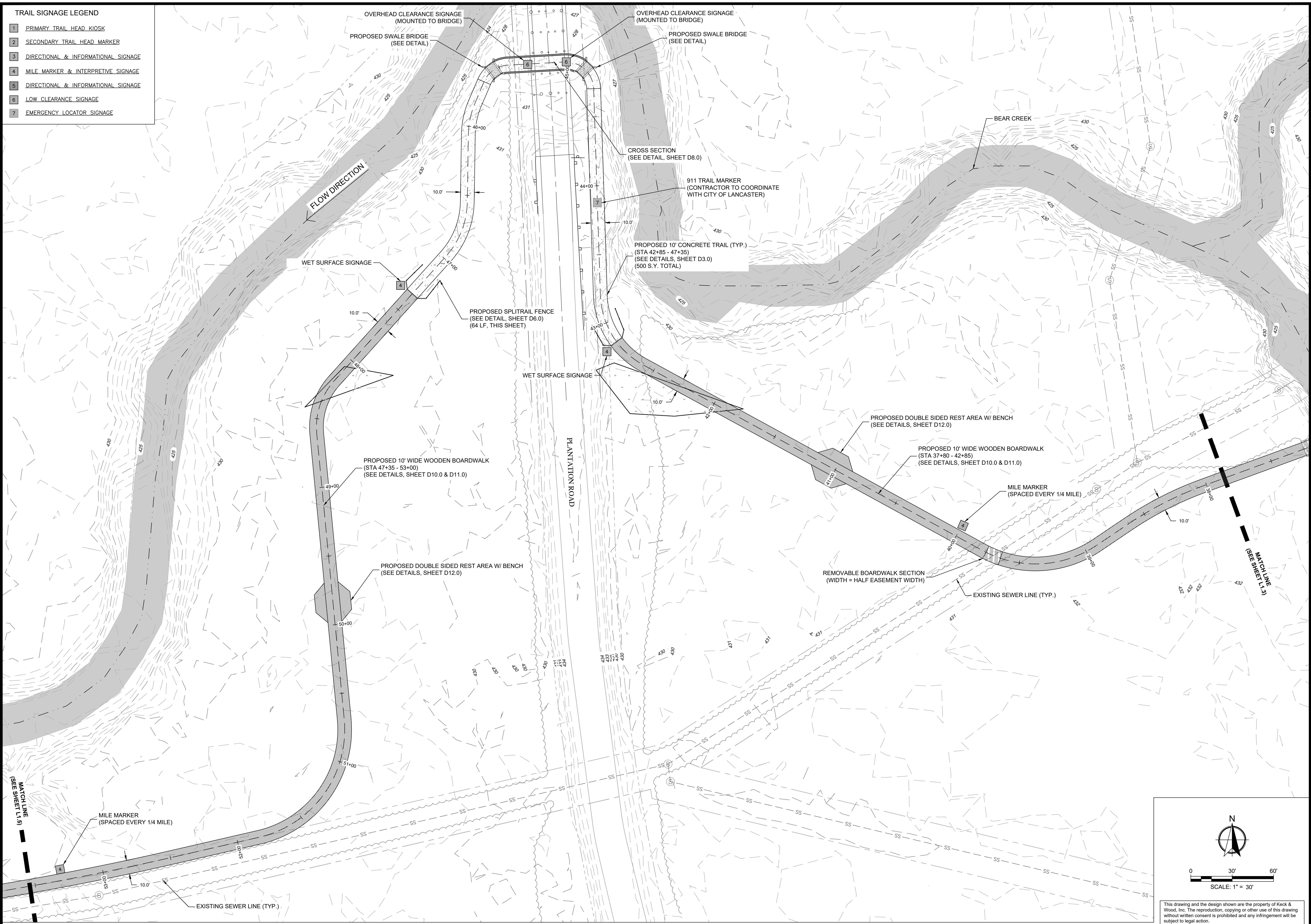

Keck+Wood
 COLLABORATION BY DESIGN
 300 TECHNOLOGY CENTER WAY, SUITE 400
 ROCK HILL, SC 29730
 (803) 620-1300
 keckwood.com

STATE OF SOUTH CAROLINA
 PROFESSIONAL LANDSCAPE ARCHITECTURE
 07-08-2022
 No. 1147
 LAWRENCE E. BARRINEAU

STATE OF SOUTH CAROLINA
 PROFESSIONAL ENGINEERING
 KECK & WOOD, INC.
 No. 006517
 DATE OF AUTHORIZATION

NO.	DATE	REVISION

Lindsay Pettus Greenway
 Phase II
 Lancaster, South Carolina
 Layout Plan

BID SET

Project Manager:	Tripp Barrineau, PLA
Drawn By:	SDG
Checked By:	CEB
Date:	07/08/2022
Scale:	As Shown

Project No.: 196770
 Drawing No.: L14

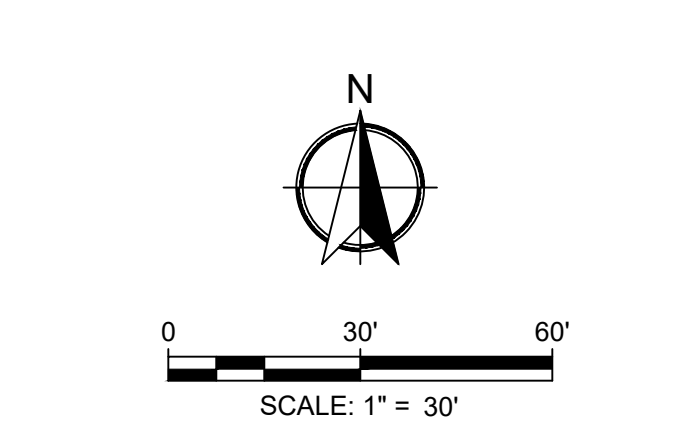

This drawing and the design shown are the property of Keck & Wood, Inc. The reproduction, copying or other use of this drawing without written consent is prohibited and any infringement will be subject to legal action.
 © 2020 Keck & Wood, Inc.

PH. II MAIN TRAIL STA: 37+80 TO 53+50

G:\Shared Drawings\2019 Projects\196770 - Lindsay Pettus Greenway - Phase II\LDQ1196770.dwg